

First Floor

Living Room	13' x 19'-5"
Kitchen	12'-6" x 13'
Dining Room	12'-8" x 13'
Master Bedroom	11'-6" x 16'
Bed Alcove	7'-9" x 8'
Bedroom	13'-4" x 16'
Master Bathroom	three-quarter
Bathroom	full

Total Heated Area 1824 sq ft

Footprint 68' x 58'

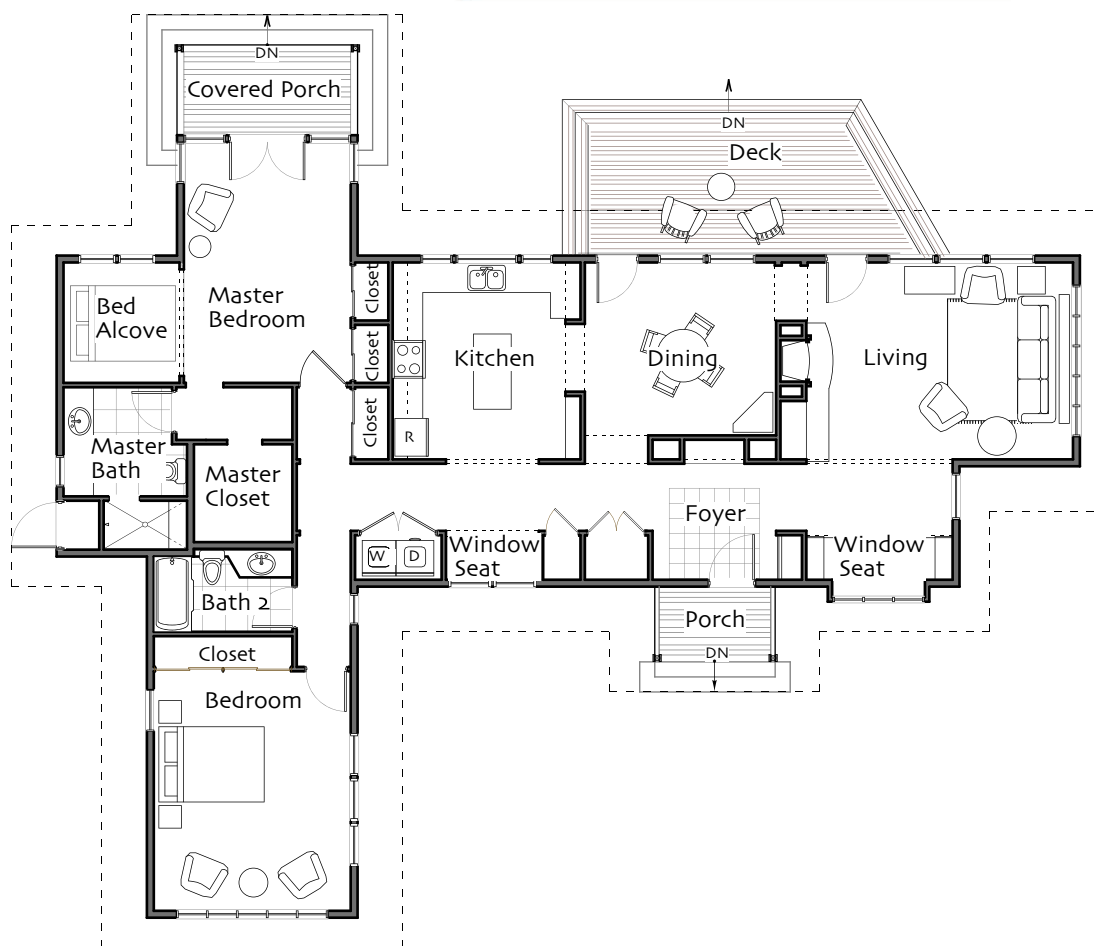

© 2020 Ross Chapin Architects • Sizes are approximate / Plans are subject to change

The GoodFit Collection

Cottages and Small Houses

PO Box 1595 . Langley, Washington 98260 . hello@goodfitplans.com . www.goodfitplans.com

**Dine's Pt.
House**